

S5220

2004-2008 FORD F150, 5.4L
REGULAR (8' BOX)/EXTENDED (NOT 8'
BOX)/CREW CAB,
CAT BACK, 3.0" TURN DOWN

MBRP®

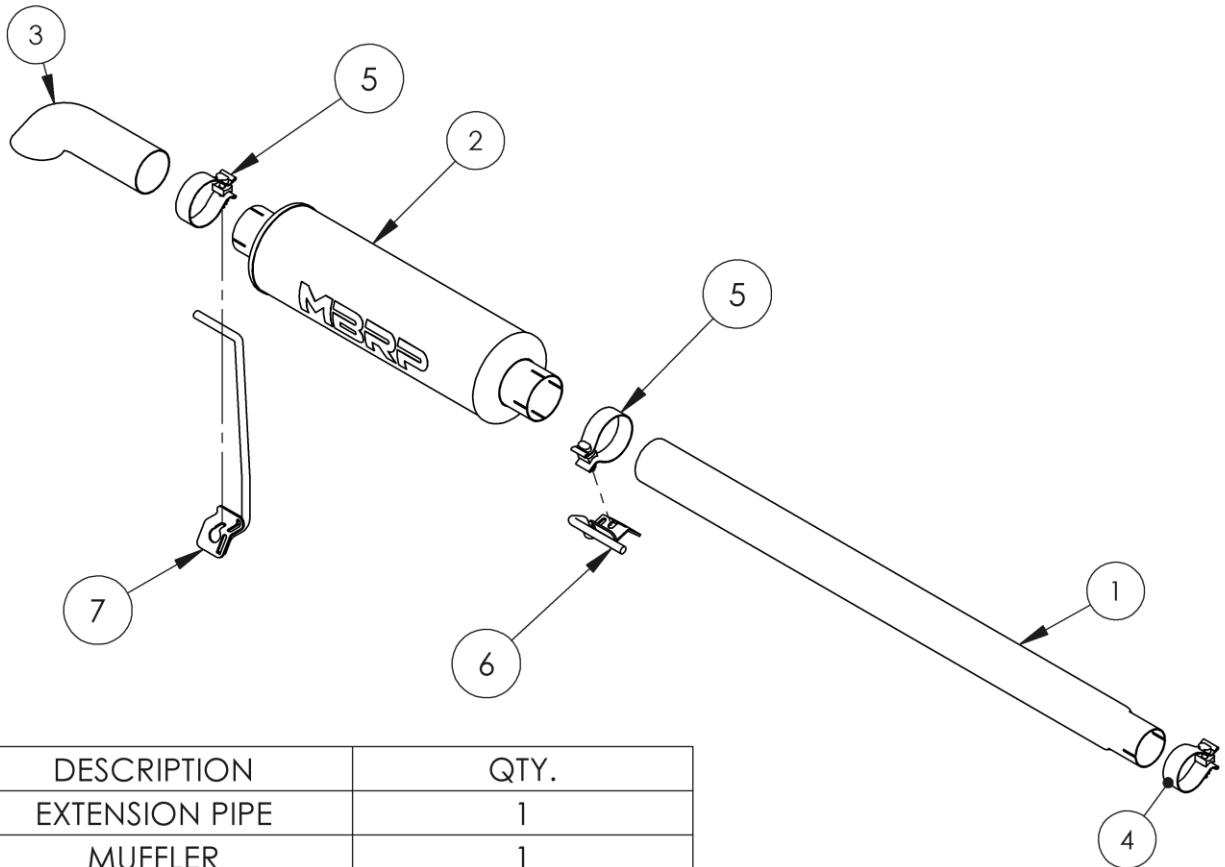

ITEM	DESCRIPTION	QTY.
1	EXTENSION PIPE	1
2	MUFFLER	1
3	TURN DOWN PIPE	1
4	2.5" CLAMP	1
5	3.0" CLAMP	2
6	HANG TIGHT™ HANGER	1
7	HANG TIGHT™ HANGER	1

PLEASE READ BEFORE STARTING INSTALLATION

While MBRP has made every effort to ensure that all components of this system are of superior quality and properly packaged, it is the installer's responsibility to ensure the following before removal of the factory exhaust:

- that ALL components shown above are present.
- that ALL mating components fit together.
- that there are no damaged components.
- that the system you have purchased is appropriate for your vehicle year, model and configuration.
- that the system will not interfere with any modifications previously installed or planned.
- that you have read and understand these instructions.

If you have any questions or are uncertain about any aspect of the installation of this system to your vehicle please contact your dealer before commencing installation.

MBRP

Removal of Stock System:



Figure 1

1. Apply a penetrating lubricant liberally to all exhaust fasteners, hangers and rubber insulators.

2. Loosen the clamp located behind the “Y” pipe.
Refer to Figure 1.

3. Loosen the clamp located in front of the muffler.
Refer to Figure 2.



Figure 2

4. Remove the hangers from the rubber insulators and remove the exhaust from the vehicle. If a hoist or hydraulic lift is not being used the tail pipe may need to be cut to clear the rear axle.
Refer to Figure 3.

Installation of MBRP Performance Exhaust:

1. Install the **Extension Pipe** to the end of the “Y” pipe. **Refer to Figure 4.**

Note: The **Extension Pipe** will need to be trimmed on some models, refer to the illustration below.



Figure 3

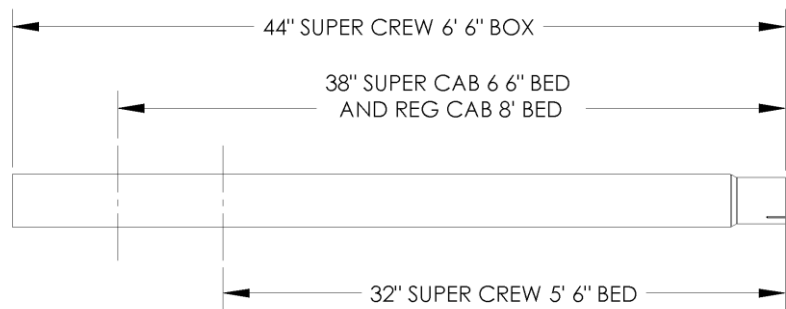
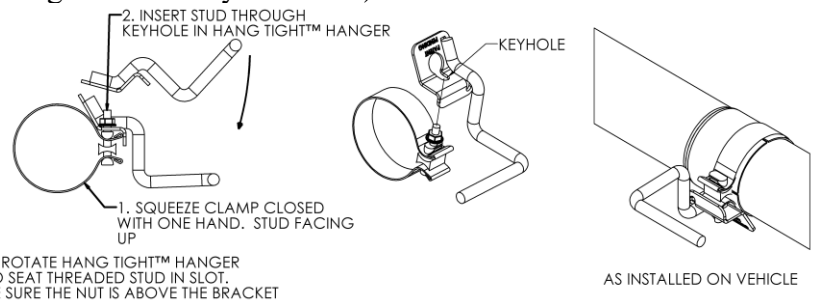

Figure 4

2. Install the **Hang Tight™** onto a **4” Band Clamp** using the procedure shown below. Snug up the nut to keep the bracket from falling out. (Hang Tight™ hanger not exactly as shown)



MBRP



Figure 5

3. Using the hanger assembly from step 2 loosely install the **Muffler** onto the **Extension Pipe**.
Refer to Figure 5.

4. Using the procedure in step 2. Install the remaining **Hang Tight™** onto the remaining **3" Band Clamp**.
Refer to Figure 6.



Figure 6

5. Using the hanger assembly from step 4 loosely install the **Turn Down** connecting it to the **Muffler**.
Refer to Figure 7.

6. Align the exhaust as required. Starting at the front of the exhaust tighten all clamps and connections.

7. Tighten all hardware and clamps, starting at the front and working rearward to secure the system. Check along the full length of the exhaust system to ensure there is adequate clearance for fuel lines, vent lines, brake lines, frame, bodywork, suspension and any wiring, etc. If there is any interference detected, relocate or adjust to provide adequate clearance. Ensure all clamp connections are secure and components are unable to rotate or slide. Band clamps require approximately 45 lb-ft (60 N-m) of torque. Verify clearances, system security and band clamp torque after 30-60 miles (50-100 km) of driving.



Figure 7



Congratulations! You are ready to begin experiencing the improved power, sound and driving excitement of your **MBRP** performance exhaust system. We know you will enjoy your purchase.